



CROWN
FIRE DOOR
PRODUCTS



**LISTED FOR EXCESSIVE
CLEARANCES AND GAPS.**

US Patent Nos. 9,151,106; 9,518,422 & 12,286,833
Canadian Patent Nos. 2,846,726 & 2,939,255



Welcome to our Crown Fire Door Products catalog! Inside you'll find innovative door gap solutions for every fire door. You'll find tried-and-true products and some updated solutions to make fixing fire door gaps even easier.

You'll find door gap solutions for:

- Swinging Doors with Builder's Hardware—Single Doors
- Paired Doors

And updates to some of our most-needed products:

- Extensions and wood door tops, with handing determined at the time of installation
- Vertical extensions for paired doors with thru-bolts no longer required

All of Crown's products have undergone rigorous, full-scale testing with UL, and are now considered "listed." Listed products are inspected through unannounced, quarterly visits to shipping facilities to ensure products are sold exactly as they were tested. To be listed for excessive clearances and gaps, products must be tested that way.

Another distinction of a product's listing is its classification. Crown products are listed as **Miscellaneous Fire Door Accessories**. This is the same distinction given to locksets and door closers. This means that applying our products to your fire door **does not constitute a field modification**. Rest assured, you're not fixing one problem and causing another!

As an **easy, cost-effective** solution, we are proud that our Crown Fire Door Products will ensure the fire door assembly's performance as an integral part of a life safety protection system, providing excellent barrier management, compartmentalizing fire as intended.

Add your name to our list of happy customers!

3-SIDED FIRE DOOR STOP FOR STEEL DOORS

CFD-001



- › UL listed for excessive clearances and gaps
- › UL tested and listed to allow for excessive clearances up to 1/2" on steel doors
- › UL fire-rated for up to 180 minutes
- › Maintains your fire door assembly's existing fire rating
- › Tested under NFPA-252 with hose stream, ANSI/UL 10B with hose stream, UL 10C, CAN/ULC S104-10
- › Compatible with Crown Latch Protector—use if latch engagement is an issue

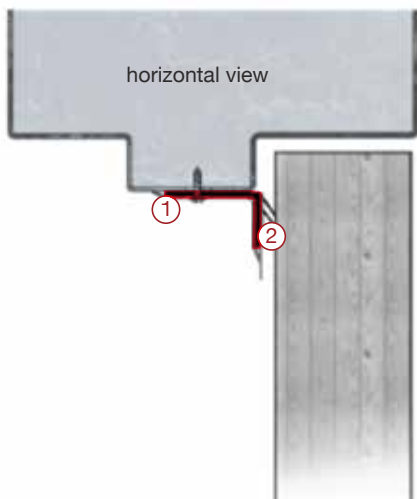

- ① Crown Fire Door Stop Top System for Steel Doors
- ② Intumescent Smoke Seal



FIRE DOOR STOP VERTICAL SYSTEM

CFD-001-E

- UL listed for excessive clearances and gaps
- UL tested and listed to allow for excessive clearances up to 1/2" on steel doors
- UL fire-rated for up to 180 minutes
- Maintains your fire door assembly's existing fire rating
- Tested under NFPA-252 with hose stream, ANSI/UL 10B with hose stream, UL 10C, CAN/ULC S104-10
- Compatible with Crown Latch Protector—use if latch engagement is an issue

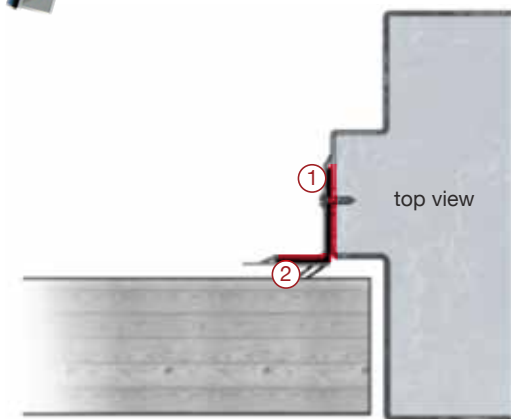

① Crown Fire Door Stop Top System for Steel Doors

② Intumescent Smoke Seal



FIRE DOOR STOP TOP SYSTEM

CFD-001-T

- > UL listed for excessive clearances and gaps
- > UL tested and listed to allow for excessive clearances up to 1/2" on steel doors
- > UL fire-rated for up to 180 minutes
- > Maintains your fire door assembly's existing fire rating
- > Tested under NFPA-252 with hose stream, ANSI/UL 10B with hose stream, UL 10C, CAN/ULC S104-10

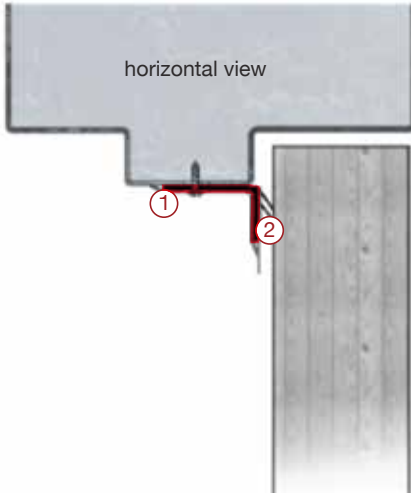

- ① Crown Fire Door Stop Top System for Steel Doors
- ② Intumescent Smoke Seal



VERTICAL EDGE PROTECTOR SYSTEM FOR WOOD DOORS

CFD-005



- > UL listed for excessive clearances and gaps
- > UL tested and listed to allow for excessive clearances up to 3/8" on wood doors
- > UL fire-rated for up to 90 minutes
- > Maintains your fire door assembly's existing fire rating
- > Tested under NFPA-252 with hose stream, ANSI/UL 108 with hose stream, UL 10C, CAN/ULC S104-10
- > Components work together as a system, install per manufacturer's instructions
- > Compatible with Crown Latch Protector—use if latch engagement is an issue

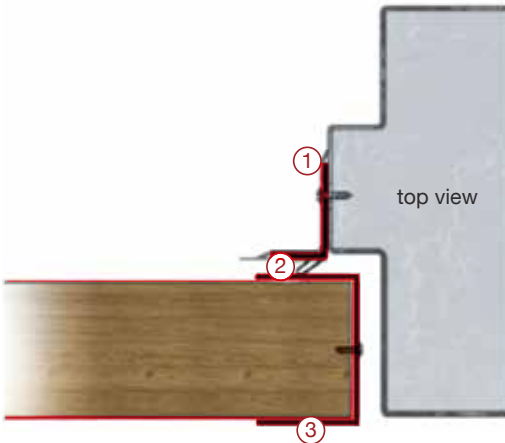

- ① Crown Fire Door Stop Top System for Steel Doors
- ② Double Intumescent Smoke Seal
- ③ Crown Steel Vertical Edge Protector



TOP PROTECTOR SYSTEM FOR WOOD DOORS

CFD-002



- > UL listed for excessive clearances and gaps
- > UL tested and listed to allow for excessive clearances up to 3/8" on wood doors
- > UL fire-rated for up to 90 minutes
- > Maintains your fire door assembly's existing fire rating
- > Tested under NFPA-252 with hose stream, ANSI/UL 10B with hose stream, UL 10C, CAN/ULC S104-10
- > A handed product: RH, LH
- > Components work together as a system, install per manufacturer's instructions

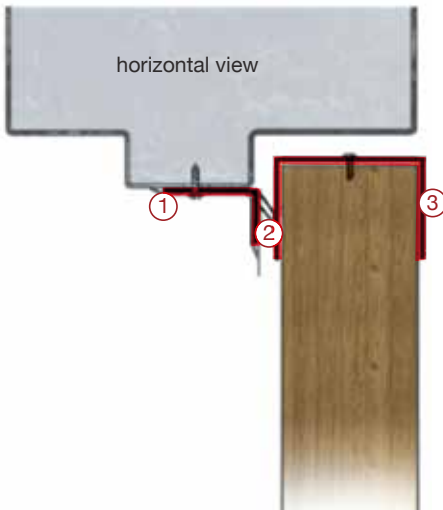

- ① Crown Fire Door Stop Top System for Steel Doors
- ② Double Intumescent Smoke Seal
- ③ Crown Fire Door Top Protector



UNIVERSAL WOOD DOOR TOP PROTECTOR

CFD-002-U



- > UL listed for excessive clearances and gaps
- > UL tested and listed to allow for excessive clearances up to 3/8" on wood doors
- > UL fire-rated for up to 90 minutes
- > Maintains your fire door assembly's existing fire rating
- > Tested under NFPA-252 with hose stream, ANSI/UL 10B with hose stream, UL 10C, CAN/ULC S104-10
- > Handing determined at the time of installation—end cap snaps on
- > Perfect for stocking
- > Easy install—no door removal required

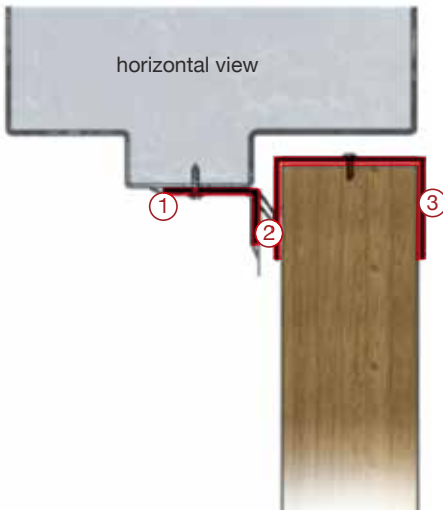

- ① Crown Fire Door Stop Top System for Steel Doors
- ② Double Intumescent Smoke Seal
- ③ Universal Wood Door Top Protector



FIRE DOOR EXTENSION

CFD-003



- UL listed for excessive clearances and gaps
- UL tested and listed to allow for excessive clearances up to 2" on steel and wood doors
- UL fire-rated for up to 90 minutes on wood doors and up to 180 minutes on steel doors
- Maintains your fire door assembly's existing fire rating
- Tested under NFPA-252 with hose stream, ANSI/UL 10B with hose stream, UL 10C, CAN/ULC S104-10
- A handed product: RH, LH, and non-handed for steel doors with no bevel
- Easy install—no door removal required

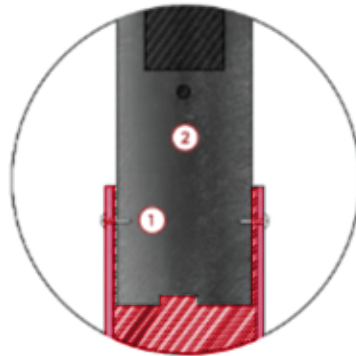

- ① Crown Fire Door Extension
- ② Steel or Wood Door



UNIVERSAL FIRE DOOR EXTENSION

CFD-003-U



- > UL listed for excessive clearances and gaps
- > UL tested and listed to allow for excessive clearances up to 2" on steel and wood doors
- > UL fire-rated for up to 90 minutes on wood doors and up to 180 minutes on steel doors
- > Maintains your fire door assembly's existing fire rating
- > Tested under NFPA-252 with hose stream, ANSI/UL 10B with hose stream, UL 10C, CAN/ULC S104-10
- > Handing determined at the time of installation—end cap snaps on
- > Perfect for stocking
- > Easy install—no door removal required



- ① Crown Universal Fire Door Extension
- ② Steel or Wood Door



CROWN LATCH PROTECTOR

CFD-004



- > UL listed for excessive clearances and gaps
- > UL tested and listed to correct latch engagement issue due to excessive clearances
- > UL fire-rated for up to 180 minutes on steel doors and 90 minutes on wood doors
- > Filler plate installed behind striker plate to increase latch penetration
- > Use with Crown Fire Door Stop to ensure proper latching if latch engagement is an issue

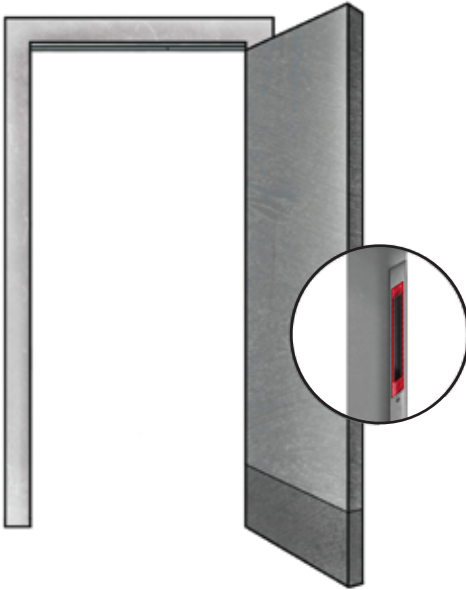

Returns latch throw into compliance



VERTICAL FIRE DOOR EXTENSION FOR PAIRED EGRESS STEEL DOORS

CFD-007-S



- › UL listed for up to 180 minutes on steel doors
- › UL listed for excessive clearances up to 1" between doors
- › Maintains your fire door assembly's existing fire rating
- › Tested under NFPA-252, ANSI/UL 10B with hose stream, UL 10C, CAN/ULC S104-10
- › Easy install—no door removal required
- › Fastens with screws; thru-bolts no longer required



VERTICAL FIRE DOOR EXTENSION FOR PAIRED EGRESS WOOD DOORS

CFD-007-W
CFD-007-WCH

- › UL listed for up to 60 minutes on wood composite doors
- › UL listed for excessive clearances up to 1" between doors
- › Maintains your fire door assembly's existing fire rating
- › Tested under NFPA-252, ANSI/UL 10B with hose stream, UL 10C, CAN/ULC S104-10
- › Easy install—no door removal required
- › Fastens with screws; thru-bolts no longer required
- › Concealed vertical rod hardware requires two 5" extensions

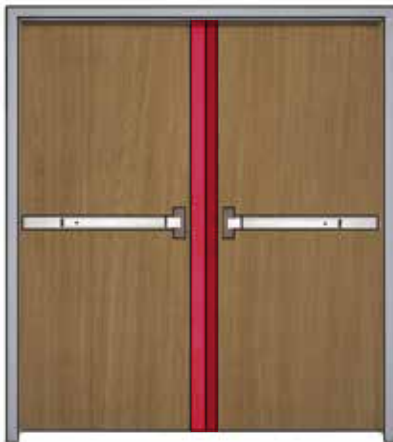

 **CROWN**
FIRE DOOR
PRODUCTS

CLASSIFIED
C  US
R27658
MISCELLANEOUS FIRE
DOOR ACCESSORY

VERTICAL FIRE DOOR EXTENSION FOR PAIRED STEEL DOORS

CFD-008-S



- > UL listed for up to 180 minutes on steel doors
- > UL listed for excessive clearances up to 1" between doors
- > Maintains your fire door assembly's existing fire rating
- > Tested under NFPA-252, ANSI/UL 10B with hose stream, UL 10C, CAN/ULC S104-10
- > Easy install—no door removal required
- > Fastens with screws; thru-bolts no longer required



VERTICAL FIRE DOOR EXTENSION FOR PAIRED WOOD DOORS

CFD-008-W



- › UL listed for up to 60 minutes on wood doors
- › UL listed for excessive clearances up to 1" between doors
- › Maintains your fire door assembly's existing fire rating
- › Tested under NFPA-252, ANSI/UL 10B with hose stream, UL 10C, CAN/ULC S104-10
- › Easy install—no door removal required
- › Fastens with screws; thru-bolts no longer required



VERTICAL FIRE DOOR EXTENSION FOR DOUBLE EGRESS STEEL DOORS

CFD-009-S



- > UL listed for up to 180 minutes on steel doors
- > UL listed for excessive clearances up to 1" between doors
- > Maintains your fire door assembly's existing fire rating
- > Tested under NFPA-252, ANSI/UL 10B with hose stream, UL 10C, CAN/ULC S104-10
- > Easy install—no door removal required
- > Fastens with screws; thru-bolts no longer required



VERTICAL FIRE DOOR EXTENSION FOR DOUBLE EGRESS WOOD DOORS

CFD-009-W
CFD-009-WCH

- > UL listed for up to 60 minutes on wood doors
- > UL listed for excessive clearances up to 1" between doors
- > Maintains your fire door assembly's existing fire rating
- > Tested under NFPA-252, ANSI/UL 10B with hose stream, UL 10C, CAN/ULC S104-10
- > Easy install—no door removal required
- > Fastens with screws; thru-bolts no longer required
- > Concealed vertical rod hardware requires two 5" extensions



 **CROWN**
FIRE DOOR
PRODUCTS

CLASSIFIED
C  US
R27658
MISCELLANEOUS FIRE
DOOR ACCESSORY



**LISTED FOR EXCESSIVE
CLEARANCES AND GAPS.**

**US Patent Nos. 9,151,106; 9,518,422 & 12,286,833
Canadian Patent Nos. 2,846,726 & 2,939,255**



Crown Fire Door Products, Inc.
(207) 206-6976
crownfiredoorproducts.com